

Blodgett 306

Hours of Operation:

Room available by reservation only.

To Reserve Room:

Please call Kathy Gabelman, ext. 3320.

Phone: ext. 2410

Physical Description

Tiered Classroom

Seats:

40

Room Inventory:

Multimedia podium with
Dell PC, VCR/DVD
Projector and screen

Software Available for Use:

- Adobe Reader 8
- Audacity (W/MP3 Converter)
- Blue J 2.13
- Compustat Software
- Cyberlink Power DVD (For playing DVDs)
- Dr. Scheme 3.70
- Drjavastable 2007828
- Eclipse 3.3 (All Plug-Ins up to 1-2-08)
- Eclipse UML
- Fathom 2
- Firefox 2.11 (w/IE Tab)
- FTP Explorer
- Geometer's Sketchpad 4.06
- Insight 2.0
- Internet Explorer 7
- Irfanview 4.1
- Java 2 SDK SE v1.6
- Junit 4.3.1
- Maple 11
- MASM615
- Microsoft Office 2003 (Service Pack 3)
- Microsoft Office 2007 (Service Pack 1)
- Minitab 15
- Mozilla 1.7 (with composer)

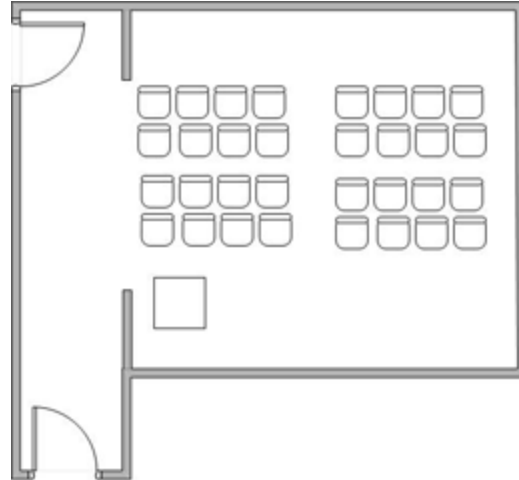

- Netbeans 5.5.1
- Netbeans 5.5.1 BlueJ Edition
- PLT Dr. Scheme 3.70
- Publisher 2003
- Quicktime 7
- Realplayer Basic Ver 11
- SmartBoard Software
- SPSS 15
- SSH Secure Shell
- Tera Term Pro
- Visual Studio 6.0 (Visual C++ 6.0, Visual Foxpro 6.0, Visual Basic 6.0)
- Windows Media Player 11
- Windows XP (Service Pack 2)
- WinRAR